

OPERATION INSTRUCTION

LED DRIVING LIGHT

LUMARY

L8182 / 8184

Specifications

- Functions: Driving Light, Position Light, Warning Light
- Excellent waterproof: IP67 & IP69K
- Comply with ECE R10, R148, R149, R65
- Heavy duty aluminium housing for efficient heat dissipation

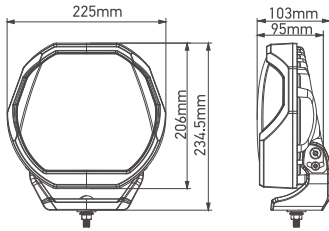

Model	Voltage	Function	Rated Power	Certification	Waterproof	Operating Temperature	Raw Lumens	Mounting
6075-200	10-30V DC	Driving Light	200W	ECE R10 ECE R148 ECE R149	IP67/IP69K	-40°C~65°C	19000lm	Bottom Bracket
		Warning Light	24W					
		Position Light	5W					



- Proper installation of this product requires the installer to have a good understanding of automotive electronics, systems and procedures.
- Failure to use specified installation parts or hardware will void the product warranty.
- For this product to operate at optimum efficiency, a good electrical connection to chassis ground must be made.
- It is recommend that these instructions be stored in a safe place and referred to when performing maintenance or reinstallation of this products.
- Do not install and/or operate this safety product unless you have read and understand the safety information contained in this manual.

Important! This unit is a safety device, and it must be connected to its own separate, fused power point to assure its continued operation should any other electrical accessory fail.

This document provides all the necessary information to allow your product to be properly and safely installed. Before beginning the installation and operation of your new product, the installation technician and operator must read this manual completely.

Mounting:

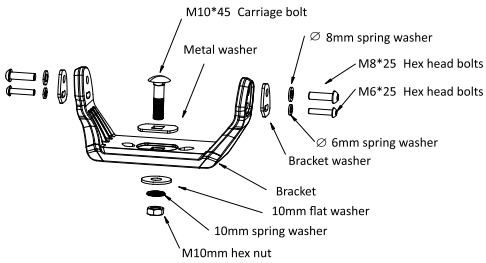

1. Choose a solid surface on the vehicle or bullbar to mount the driving lamp.
2. Read the safety note before installing the products. Verify that all power supply comply to the specified voltage limits for the light.
3. Verify that all parts listed under “In the Box” are present and complete.

Wiring Instruction

The wiring for this configuration is as shown in pictures below.

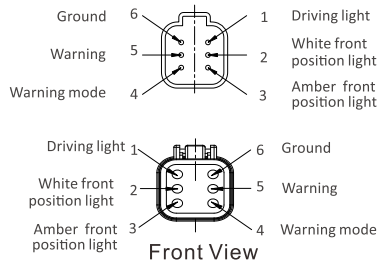
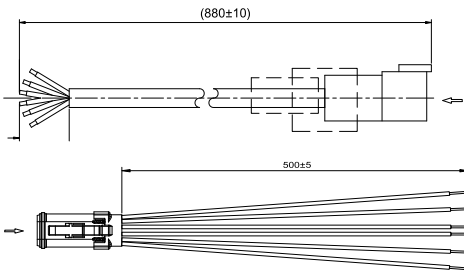

Cable Color and Wiring Function Table

1	Red 14AWG	Driving light
2	Yellow 20AWG	White front position light
3	White 20AWG	Amber front position light
4	Green 20AWG	Warning mode
5	Blue 20AWG	Warning light
6	Black 14AWG	Ground